

**Product**

- Purist wall mount shower arm

**Kohler Code**

45918T-CP

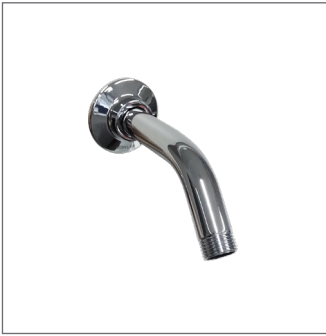

**Included Components**

- Shower arm
- Escutcheon

**Features**

- Wall mount
- Polished chrome
- KOHLER finishes resist tarnishing and corrosion

**Technical Details**

Side View

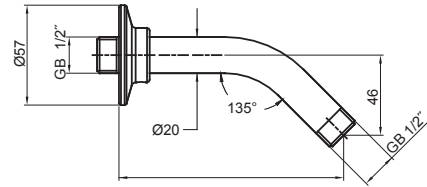

**Installation Notes:**

- Water inlet & outlet GB 1/2" male connectors.
- Optimum working pressure 300-500 kPa.
- Inline filters should be used to protect tapware from debris that may be present within the plumbing.

**Product**

- Wall mount shower arm

**Kohler Code**

16346A-CP



**Included Components**

- Shower arm
- Escutcheon

**Features**

- Wall mount
- Polished chrome
- KOHLER finishes resist tarnishing and corrosion

**Technical Details**

Side View

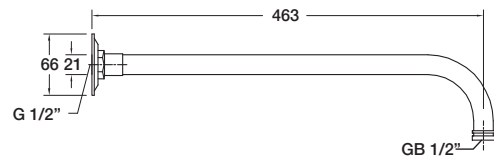

**Installation Notes:**

- Water inlet G 1/2" female, water outlet GB 1/2" male.
- Optimum working pressure 300-500 kPa.
- Inline filters should be used to protect tapware from debris that may be present within the plumbing.

**Product**

- Ceiling mount shower arm

**Kohler Code**

16347A-CP



**Included Components**

- Shower arm
- Escutcheon

**Features**

- Ceiling mount
- Polished chrome
- KOHLER finishes resist tarnishing and corrosion

**Technical Details**

Side View

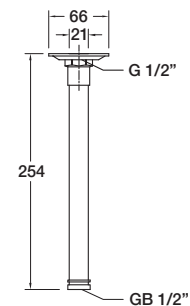

**Installation Notes:**

- Water inlet G 1/2" female, water outlet GB 1/2" male.
- Optimum working pressure 300-500 kPa.
- Inline filters should be used to protect tapware from debris that may be present within the plumbing.